

## DÜZENLEME SINIR KROKİSİ

İLİ : YALOVA  
İLÇESİ : ÇINARCIK  
MAH : HARMANLAR  
PAFTA : G22D13A2C  
ADA : 261 803  
PARSEL : 1 İLA 6 1+2+3+4  
13+14+15

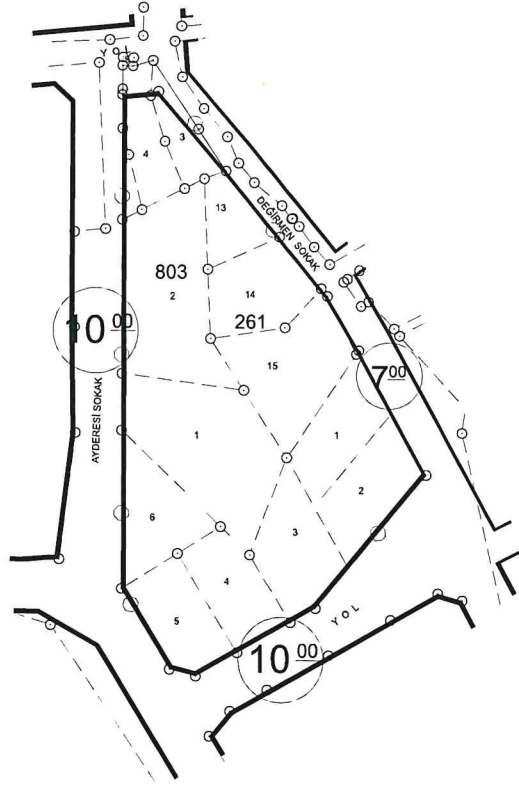
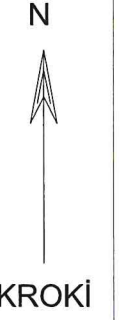
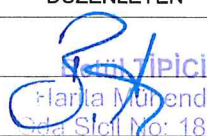

- Düzenleme Sınırı  
- - - - - Uygulamaya Tabi Parsel Sınırları  
————— Ada / Blok Sınırları

	DÜZENLEYEN	KONTROL EDEN	ONAYLAYAN
ADI SOYADI			
TARİH	Harika Mühendisi Mühür No: 18797		
İMZA	25.12.2024		

İLİ : YALOVA  
İLÇESİ : ÇINARCIK  
MAH : HARMANLAR  
PAFTA : G22D13A2C  
ADA : 261 803  
PARSEL : 1 İLA 6 1+2+3+4  
13+14+15

## PARSELASYON PLANI



1/1000

4501100

4501000

4500900

425500

425600

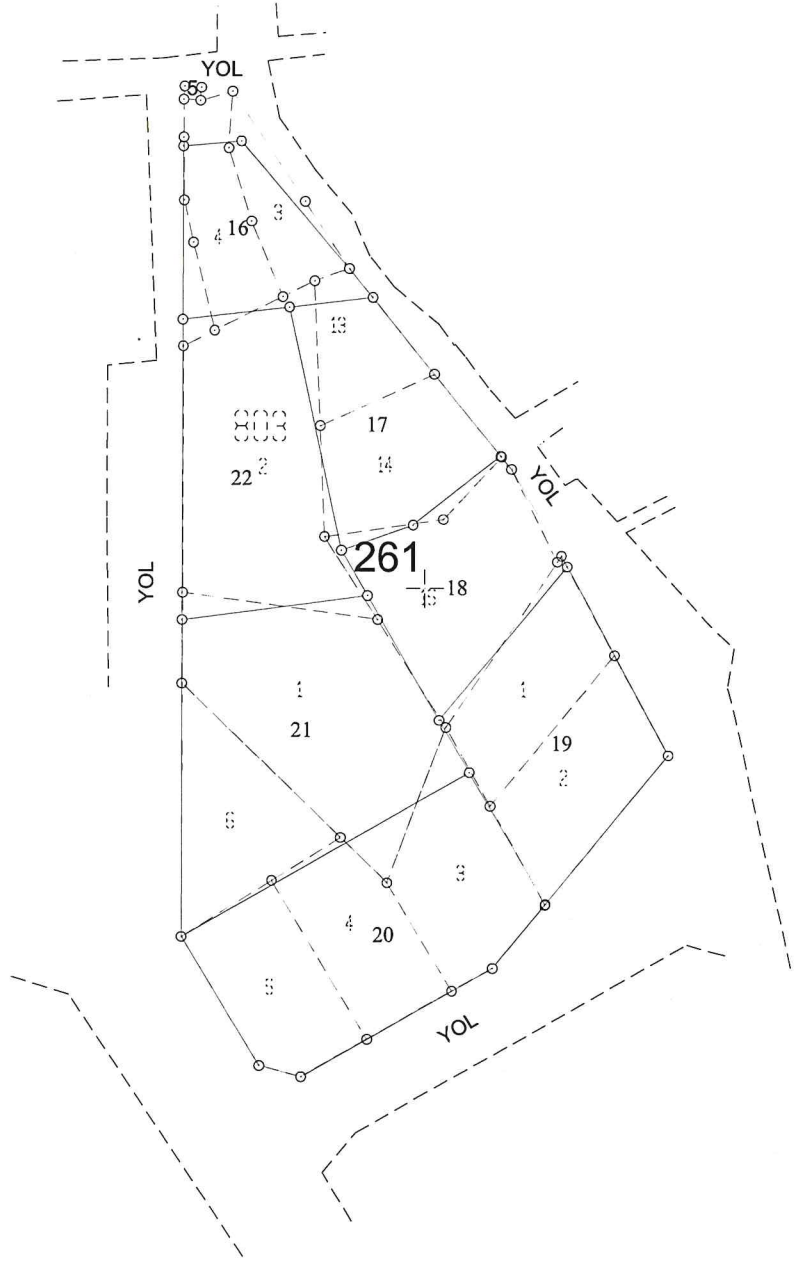

	DÜZENLEYEN	UYGUNDUR BELEDİYE/ÖZEL İDARE	
		KONTROL EDEN	ONAYLAYAN
ADI SOYADI			
TARİH	Harun Mühendisi Mühür Sicil No: 18797		
İMZA	07.01.2025		

İLİ : YALOVA  
İLÇESİ : ÇINARCIK  
KÖYÜ/MAHALLESİ: ÇINARCIK  
T.C. ÇINARCIK

BELEDİYESİ  
NOLU UYGULAMA SAHASI

## Ö Z E T C E T V E L İ

Ada/Par	Alan	Kamu.	Y.Terk	D.Girmeyen	Dopal	Dopalma	Dop	İ.Tahsis	İ M A R	
									AdaNo	Alan
261/1	327.93	-	-	-	0.00	327.93	0.00	327.93	261	4998.12
261/2	363.73	-	-	-	0.00	363.73	0.00	363.73		
261/3	377.36	-	-	-	0.00	377.36	0.00	377.36		
261/4	314.03	-	-	-	0.00	314.03	0.00	314.03		
261/5	334.80	-	-	-	0.00	334.80	0.00	334.80		
261/6	355.43	-	-	-	0.00	355.43	0.00	355.43		
261/13	189.98	-	-	-	0.00	189.98	0.00	189.98		
261/14	346.15	-	-	-	0.00	346.15	0.00	346.15		
261/15	514.18	-	-	-	0.00	514.18	0.00	514.18		
803/1	776.71	-	35.42	-	802.13	-	40.77	761.36		
803/2	741.18	-	34.34	-	775.52	-	39.42	736.10		
803/3	168.18	-	-	-	168.18	-	8.55	159.63		
803/4	229.09	-	-	-	229.09	-	11.65	217.44		

K A D A S T R O T O P L A M L A R I	Toplam Alan	Toplam Kamu	Toplam Y.Terk	Toplam D.Girmeyen	Toplam Dopal	Top. Dopalma	Düz. Giren Dop	Toplam Tahsis	İ M A R	
									Toplam Alan	Toplam Alan
5098.51	5098.51	0.00	69.76	0.00	1974.92	3123.59	100.39	4998.12		4998.12

## Düzenleme Ortaklık Payı Hesabı

Düzenlemeye Giren Alanlar (R1) = 1974.92  
Eski DOPO > Proje DOPO Alanlar (D1) = 0.00  
İmar Alanları (R2) = 4998.12  
Eski DOPO > Proje DOPO Tahsisler (D2) = 0.00  
DOP Alınmayan Alanlar (R3) = 3123.59  
Düzenleme Ortaklık Payı = (R1 - D1 - R2 + D2 + R3) / (R1-D1)

Ortak Katılım Oranı = 0.0000000  
Düzenleme Ortaklık Payı Oranı (DOPO) = 0.0508324  
DOPO (OKO ile birlikte) = 0.0508324  
Maksimum Dop Oranı = 0.45





TOPLAM ALAN : 5098.51		M A L S A H İ P L E R İ A R A Ş T I R M A						SAYFA NO:1			
TOPLAM PAY : 5098.51		V E						TOPLAM ADA ALANI : 4998.12			
TOPLAM KAMULAŞTIRMA : 0.00		Ö Z E T F O R M U						O. KATILIM ORANI : 0.0000000			
TOP. DÜZENLE. GİRMEYEN: 0.00		( K A D A S T R O P A R S E L İ N E S I R A L I )						D. O. PAYI ORANI : 0.0508324			
TOP. DÜZENLEMEYE GİREN: 5098.51											
K A D A S T R O							M A R				
SNo	Pafta	Ada/Par	Alan/Pay	Hisse	Mallık/Baba Adı	Kamu	Dop/İTh	Ada/Par	Alan	Hisse	Pay
1	G22D13A2C	261/1	327.93 109.31	1 3	AHMET DURMUŞOĞLU NAZİF	-	- 109.32	261/19	691.66	10932/69166	109.32
2	G22D13A2C	261/1	327.93 109.31	1 3	HİDAYET GÜNER NAZİF	-	- 109.31	261/19	691.66	10931/69166	109.31
3	G22D13A2C	261/1	327.93 54.66	1 6	MELİKE DURMUŞOĞLU MEHMET	-	- 54.65	261/19	691.66	5465/69166	54.65
4	G22D13A2C	261/1	327.93 54.66	1 6	MELİH DURMUŞOĞLU MEHMET	-	- 54.65	261/19	691.66	5465/69166	54.65
5	G22D13A2C	261/2	363.73 121.24	1 3	AHMET DURMUŞOĞLU NAZİF	-	- 121.25	261/19	691.66	12125/69166	121.25
6	G22D13A2C	261/2	363.73 121.24	1 3	HİDAYET GÜNER NAZİF	-	- 121.24	261/19	691.66	12124/69166	121.24
7	G22D13A2C	261/2	363.73 60.62	1 6	MELİKE DURMUŞOĞLU MEHMET	-	- 60.62	261/19	691.66	6062/69166	60.62
8	G22D13A2C	261/2	363.73 60.62	1 6	MELİH DURMUŞOĞLU MEHMET	-	- 60.62	261/19	691.66	6062/69166	60.62
9	G22D13A2C	261/3	377.36 188.68	1 2	PINAR ARMAĞAN ZİYA	-	- 188.68	261/20	1026.19	18868/102619	188.68
10	G22D13A2C	261/3	377.36 188.68	1 2	KEZİBAN KAYA ŞEVKİ	-	- 188.68	261/20	1026.19	18868/102619	188.68
11	G22D13A2C	261/4	314.03 157.02	1 2	KEZİBAN KAYA ŞEVKİ	-	- 157.02	261/20	1026.19	15702/102619	157.02
12	G22D13A2C	261/4	314.03 157.02	1 2	MURAT KAYA ZİYA	-	- 157.01	261/20	1026.19	15701/102619	157.01
13	G22D13A2C	261/5	334.80 334.80	TAM	MURAT KAYA ZİYA	-	- 334.80	261/20	1026.19	33480/102619	334.80
14	G22D13A2C	261/6	355.43 355.43	TAM	FAHRETTİN KOÇ FAHRİ	-	- 355.43	261/21	1116.79	35543/111679	355.43
15	G22D13A2C	261/13	189.98 38.00	1 5	İSMAIL DAL RECEP	-	- 37.99	261/17	536.13	3799/53613	37.99
16	G22D13A2C	261/13	189.98 38.00	1 5	PENBE DAL RECEP	-	- 37.99	261/17	536.13	3799/53613	37.99
17	G22D13A2C	261/13	189.98 38.00	1 5	HATİCE ÖZEN RECEP	-	- 38.00	261/17	536.13	3800/53613	38.00
18	G22D13A2C	261/13	189.98 38.00	1 5	AYŞE ÖZER RECEP	-	- 38.00	261/17	536.13	3800/53613	38.00
19	G22D13A2C	261/13	189.98 12.67	1 15	AYSUN ÇERÇİOĞLU YILMAZ	-	- 12.67	261/17	536.13	1267/53613	12.67
20	G22D13A2C	261/13	189.98 12.67	1 15	ERDİNÇ UÇAR YILMAZ	-	- 12.67	261/17	536.13	1267/53613	12.67
21	G22D13A2C	261/13	189.98 4.22	1 45	YILMAZ KAZIM UÇAR ERGÜN	-	- 4.22	261/17	536.13	422/53613	4.22
22	G22D13A2C	261/13	189.98 4.22	1 45	EMRE UÇAR ERGÜN	-	- 4.22	261/17	536.13	422/53613	4.22
23	G22D13A2C	261/13	189.98 4.22	1 45	AZİZ UÇAR ERGÜN	-	- 4.22	261/17	536.13	422/53613	4.22
24	G22D13A2C	261/14	346.15 173.07	1 2	YÜCEL TÜRKAN HAMİT	-	- 173.08	261/17	536.13	17308/53613	173.08
25	G22D13A2C	261/14	346.15 173.07	1 2	GÖKSEL TÜRKAN HAMİT	-	- 173.07	261/17	536.13	17307/53613	173.07
26	G22D13A2C	261/15	514.18 102.84	1 5	PENBE DAL RECEP	-	- 102.84	261/18	514.18	10284/51418	102.84
27	G22D13A2C	261/15	514.18 411.34	4 5	İSMAIL DAL RECEP	-	- 411.34	261/18	514.18	41134/51418	411.34
28	G22D13A2C	803/1	802.13 802.13	TAM	FAHRETTİN KOÇ FAHRİ	-	- 40.77 761.36	261/21	1116.79	76136/111679	761.36
29	G22D13A2C	803/2	775.52 193.88	1 4	SELMİNAZ ARSLAN ALİ	-	- 9.86 184.03	261/22	736.10	18403/73610	184.03

  
 Mustafa Arpacı  
 Harita Mühendisi  
 Oluşum Sicil No: 18797  
 07.01.2025

SAYFA NO:2

M A L S A H | P L E R | A R A Ş T I R M A

TOPLAM ALAN : 5098.51

TOPLAM PAY : 5098.51

TOPLAM KAMULAŞTIRMA : 0.00

TOP. DÜZENLE. GİRMEYEN: 0.00

TOP. DÜZENLEMEME GİREN: 5098.51

TOPLAM ADA ALANI : 4998.12  
O.KATILIM ORANI : 0.0000000  
D.O.PAYI ORANI : 0.0508324Ö Z E T F O R M U  
( K A D A S T R O P A R S E L İ N E S İ R A L I )

SNo	Pafta	Ada/Par	Alan/Pay	Hisse	Mallik/Baba Adı	Kamu	Dop/Th	Ada/Par	Alan	Hisse	Pay	İ M A R		
30	G22D13A2C	803/2	775.52 193.88	1 4	AYSEL ARSLAN ZİYAFET	-	9.86 184.03	261/22	736.10	18403/73610	184.03			
31	G22D13A2C	803/2	775.52 193.88	1 4	MÜNEVVER ARSLAN MUSTAFA	-	9.86 184.02	261/22	736.10	18402/73610	184.02			
32	G22D13A2C	803/2	775.52 193.88	1 4	SEDA ARSLAN MEHMET	-	9.86 184.02	261/22	736.10	18402/73610	184.02			
33	G22D13A2C	803/3	168.18 168.18	TAM	EMİNE TETİK AHMET	-	8.55 159.63	261/16	377.07	15963/37707	159.63			
34	G22D13A2C	803/4	229.09 57.27	1 4	REMZİYE TETİK HASAN	-	2.91 54.36	261/16	377.07	5436/37707	54.36			
35	G22D13A2C	803/4	229.09 57.27	1 4	NALAN YEGİN ZEKERİYA	-	2.91 54.36	261/16	377.07	5436/37707	54.36			
36	G22D13A2C	803/4	229.09 57.27	1 4	KAMURAN TETİK ZEKERİYA	-	2.91 54.36	261/16	377.07	5436/37707	54.36			
37	G22D13A2C	803/4	229.09 57.27	1 4	NEŞEHAN TETİK ZEKERİYA	-	2.91 54.36	261/16	377.07	5436/37707	54.36			

**BETÜL TİPİCİ**  
Pafta Mühendisi  
Oda Sicil No: 48797  
07.01.2025

TOPLAM ALAN : 5098.51	T E S C İ L E E S A S				SAYFA NO:1			
TOPLAM PAY : 5098.51	D A Ğ I T I M C E T V E L İ				TOPLAM ADA ALANI : 4998.12			
TOPLAM KAMULAŞTIRMA : 0.00	( İ M A R P A R S E L İ N E S I R A L I )				O. KATILIM ORANI : 0.0000000			
TOP. DÜZENLE GİRMEYEN : 0.00					D.O. PAYI ORANI : 0.0506324			
TOP. DÜZENLEMEYE GİREN : 5098.51								

K A D A S T R O							İ M A R				
SNo	Fafta	Ada/Par	Alan	Hisse	Malik/Baba Adı	Kamu	Dop/Th	Ada/Par	Alan	Hisse	Pay
33	G22D13A2C	803/3	168.18	TAM	EMİNE TETİK	-	8.55	261/16	377.07	15963/37707	159.63
34		803/4	229.09	168.18	AHMET	-	159.63			5436/37707	54.36
35		803/4	229.09	1/4	REMZYİYE TETİK	-	2.91			5436/37707	54.36
36		803/4	229.09	57.27	HASAN	-	54.36			5436/37707	54.36
37		803/4	229.09	1/4	NALAN YEĞİN	-	2.91			5436/37707	54.36
				57.27	ZEKERİYA	-	54.36			5436/37707	54.36
				1/4	KAMURAN TETİK	-	2.91			5436/37707	54.36
				57.27	ZEKERİYA	-	54.36			5436/37707	54.36
				1/4	NEŞELHAN TETİK	-	2.91			5436/37707	54.36
				57.27	ZEKERİYA	-	54.36			5436/37707	54.36
15	G22D13A2C	261/13	189.98	1/5	İSMAL DAL	-	-	261/17	536.13	3799/53613	37.99
16		261/13	189.98	38.00	RECEP	-	37.99			3799/53613	37.99
17		261/13	189.98	1/5	PENBE DAL	-	-			3800/53613	38.00
18		261/13	189.98	38.00	HATİCE ÖZEN	-	37.99			3800/53613	38.00
19		261/13	189.98	1/5	AYŞE ÖZER	-	-			3800/53613	38.00
20		261/13	189.98	38.00	RECEP	-	38.00			1267/53613	12.67
21		261/13	189.98	1/15	AYSUN CERÇİOĞLU	-	-			1267/53613	12.67
22		261/13	189.98	12.67	YILMAZ	-	12.67			422/53613	4.22
23		261/13	189.98	1/15	ERDİNÇ UÇAR	-	-			422/53613	4.22
24		261/13	189.98	12.67	YILMAZ	-	12.67			422/53613	4.22
25		261/13	189.98	1/45	YILMAZ KAZIM UÇAR	-	-			422/53613	4.22
26		261/13	189.98	4.22	ERGÜN	-	4.22			17308/53613	173.08
27		261/13	189.98	1/45	EMRE UÇAR	-	-			17307/53613	173.07
28		261/13	189.98	4.22	ERGÜN	-	4.22				
29		261/14	346.15	1/2	YÜCEL TÜRKAN	-	-				
30		261/14	346.15	173.07	HAMİT	-	173.08				
31		261/14	346.15	1/2	GÖKSEL TÜRKAN	-	-				
32		261/14	346.15	173.07	HAMİT	-	173.07				
26	G22D13A2C	261/15	514.18	1/5	PENBE DAL	-	-	261/18	514.18	10284/51418	102.84
27		261/15	514.18	102.84	RECEP	-	102.84			41134/51418	411.34
28		261/15	514.18	4/5	İSMAL DAL	-	-				
29		261/15	514.18	411.34	RECEP	-	411.34				
1	G22D13A2C	261/1	327.93	1/3	AHMET DURMUŞOĞLU	-	-	261/19	691.66	10932/69166	109.32
2		261/1	327.93	109.31	NAZİF	-	109.32			10931/69166	109.31
3		261/1	327.93	1/3	HİDAYET GÜNER	-	-			5465/69166	54.65
4		261/1	327.93	109.31	NAZİF	-	109.31			5465/69166	54.65
5		261/1	327.93	1/6	MELİKE DURMUŞOĞLU	-	-			12125/69166	121.25
6		261/1	327.93	54.66	MEHMET	-	54.65			12124/69166	121.24
7		261/1	327.93	1/6	MELİH DURMUŞOĞLU	-	-			6062/69166	60.62
8		261/2	363.73	54.66	MEHMET	-	54.65			6062/69166	60.62
9		261/2	363.73	1/3	AHMET DURMUŞOĞLU	-	-				
10		261/2	363.73	121.24	NAZİF	-	121.25				
11		261/2	363.73	1/3	HİDAYET GÜNER	-	-				
12		261/2	363.73	121.24	NAZİF	-	121.24				
13		261/2	363.73	1/6	MELİKE DURMUŞOĞLU	-	-				
14		261/2	363.73	60.62	MEHMET	-	60.62				
15		261/2	363.73	1/6	MELİH DURMUŞOĞLU	-	-				
16		261/2	363.73	60.62	MEHMET	-	60.62				
9	G22D13A2C	261/3	377.36	1/2	PINAR ARMAĞAN	-	-	261/20	1026.19	18868/102619	188.68
10		261/3	377.36	188.68	ZİYA	-	188.68			18868/102619	188.68
11		261/3	377.36	1/2	KEZİBAN KAYA	-	-			15702/102619	157.02
12		261/4	314.03	188.68	ŞEVKİ	-	188.68			15701/102619	157.01
13		261/4	314.03	1/2	KEZİBAN KAYA	-	-				
14		261/4	314.03	157.02	ŞEVKİ	-	157.02				
15		261/4	314.03	1/2	MURAT KAYA	-	-				
16		261/5	334.80	157.02	ZİYA	-	157.01				
17		261/5	334.80	1/2	MURAT KAYA	-	-				
18		261/5	334.80	157.02	ZİYA	-	157.01				
19		261/5	334.80	1/2	MURAT KAYA	-	-				
20		261/5	334.80	157.02	ZİYA	-	157.01				
21		261/5	334.80	1/2	MURAT KAYA	-	-				
22		261/5	334.80	157.02	ZİYA	-	157.01				
23		261/5	334.80	1/2	MURAT KAYA	-	-				
24		261/5	334.80	157.02	ZİYA	-	157.01				
25		261/5	334.80	1/2	MURAT KAYA	-	-				
26		261/5	334.80	157.02	ZİYA	-	157.01				
27		261/5	334.80	1/2	MURAT KAYA	-	-				
28		261/5	334.80	157.02	ZİYA	-	157.01				
29		261/5	334.80	1/2	MURAT KAYA	-	-				
30		261/5	334.80	157.02	ZİYA	-	157.01				
31		261/5	334.80	1/2	MURAT KAYA	-	-				
32		261/5	334.80	157.02	ZİYA	-	157.01				
33		261/5	334.80	1/2	MURAT KAYA	-	-				
34		261/5	334.80	157.02	ZİYA	-	157.01				
35		261/5	334.80	1/2	MURAT KAYA	-	-				
36		261/5	334.80	157.02	ZİYA	-	157.01				
37		261/5	334.80	1/2	MURAT KAYA	-	-				
38		261/5	334.80	157.02	ZİYA	-	157.01				
39		261/5	334.80	1/2	MURAT KAYA	-	-				
40		261/5	334.80	157.02	ZİYA	-	157.01				
41		261/5	334.80	1/2	MURAT KAYA	-	-				
42		261/5	334.80	157.02	ZİYA	-	157.01				
43		261/5	334.80	1/2	MURAT KAYA	-	-				
44		261/5	334.80	157.02	ZİYA	-	157.01				
45		261/5	334.80	1/2	MURAT KAYA	-	-				
46		261/5	334.80	157.02	ZİYA	-	157.01				
47		261/5	334.80	1/2	MURAT KAYA	-	-				
48		261/5	334.80	157.02	ZİYA	-	157.01				
49		261/5	334.80	1/2	MURAT KAYA	-	-				
50		261/5	334.80	157.02	ZİYA	-	157.01				
51		261/5	334.80	1/2	MURAT KAYA	-	-				
52		261/5	334.80	157.02	ZİYA	-	157.01				
53		261/5	334.80	1/2	MURAT KAYA	-	-				
54		261/5	334.80	157.02	ZİYA	-	157.01				
55		261/5	334.80	1/2	MURAT KAYA	-	-				
56		261/5	334.80	157.02	ZİYA	-	157.01				
57		261/5	334.80	1/2	MURAT KAYA	-	-				
58		261/5	334.80	157.02	ZİYA	-	157.01				
59		261/5	334.80	1/2	MURAT KAYA	-	-				
60		261/5	334.80	157.02	ZİYA	-	157.01				
61		261/5	334.80	1/2	MURAT KAYA	-	-				
62		261/5	334.80	157.02	ZİYA	-	157.01				
63		261/5	334.80	1/2	MURAT KAYA	-	-				
64		261/5	334.80	157.02	ZİYA	-	157.01				
65		261/5	334.80	1/2	MURAT KAYA	-	-				
66		261/5	334.80	157.02	ZİYA	-	157.01				
67		261/5	334.80	1/2	MURAT KAYA	-	-				
68		261/5	334.80	157.02	ZİYA	-	157.01				
69		261/5	334.80	1/2	MURAT KAYA	-	-				
70		261/5	334.80	157.02	ZİYA	-	157.01				
71		261/5	334.80	1/2	MURAT KAYA	-	-				
72		261/5	334.80	157.02	ZİYA	-	157.01				
73		261/5	334.80	1/2	MURAT KAYA	-	-				
74		26									



İLİ : YALOVA  
İLÇESİ : ÇINARCIK  
KÖY/MAH. : ÇINARCIK  
BELEDİYESİ : ÇINARCIK  
PAFTANO : G22D13A2C

T E S C İ L S A Y F A S I

SAYFA NO:1

ADANO : 261

Cilt	Syf	Alan		Cinsi	Hisse	Kada	KPar	Cilt	Syf.	Maliki	Babası
		He.	M2								
		16	0 0377	07 ARSA	15963/37707	803	3	16	1481	EMİNE TETİK	AHMET ZEKERİYA
					21744/37707	803	4	16	1480	KAMURAN TETİK	ZEKERİYA
						803	4	16	1480	NALAN YEĞİN	ZEKERİYA
						803	4	16	1480	NESLİHAN TETİK	ZEKERİYA
						803	4	16	1480	REMZİYE TETİK	HASAN
		17	0 0536	13 ARSA	3800/53613	261	13	75	7573	AYŞE ÖZER	RECEP
					3800/53613	261	13	75	7573	HATİCE ÖZEN	RECEP
					3799/53613	261	13	75	7573	İSMAIL DAL	RECEP
					3799/53613	261	13	75	7573	PENBE DAL	RECEP
						261	13	75	7573	AYSUN ÇERÇİOĞLU	YILMAZ
						261	13	75	7573	AZİZ UÇAR	ERGÜN
					3800/53613	261	13	75	7573	EMRE UÇAR	ERGÜN
						261	13	75	7573	ERDİNÇ UÇAR	YILMAZ
						261	13	75	7573	YILMAZ KAZIM UÇAR	ERGÜN
					17307/53613	261	14	75	7574	GÖKSEL TÜRKAN	HAMİT
					17308/53613	261	14	75	7574	YÜCEL TÜRKAN	HAMİT
		18	0 0514	18 ARSA	4/5	261	15	75	7575	İSMAIL DAL	RECEP
					1/5	261	15	75	7575	PENBE DAL	RECEP
		19	0 0691	66 ARSA	32793/69166	261	1	114	11394	AHMET DURMUŞOĞLU	NAZİF
						261	1	114	11394	HİDAYET GÜNER	NAZİF
						261	1	114	11394	MELİH DURMUŞOĞLU	MEHMET
						261	1	114	11394	MELİKE DURMUŞOĞLU	MEHMET
						261	2	114	11395	AHMET DURMUŞOĞLU	NAZİF
						261	2	114	11395	HİDAYET GÜNER	NAZİF
					36373/69166	261	2	114	11395	MELİH DURMUŞOĞLU	MEHMET
						261	2	114	11395	MELİKE DURMUŞOĞLU	MEHMET
		20	0 1026	19 ARSA	18868/102619	261	3	114	11396	KEZİBAN KAYA	ŞEVKİ
					18868/102619	261	3	114	11396	PINAR ARMAĞAN	ZİYA
					15702/102619	261	4	114	11397	KEZİBAN KAYA	ŞEVKİ
					15701/102619	261	4	114	11397	MURAT KAYA	ZİYA
					33480/102619	261	5	114	11398	MURAT KAYA	ZİYA
		21	0 1116	79 ARSA	35543/111679	261	6	114	11399	FAHRETTİN KOÇ	FAHRİ
					76136/111679	803	1	115	11542	FAHRETTİN KOÇ	FAHRİ
		22	0 0736	10 ARSA	1/4	803	2	115	11543	AYSEL ARSLAN	ZİYAFET
					1/4	803	2	115	11543	MÜNEVVER ARSLAN	MUSTAFA
					1/4	803	2	115	11543	SEDA ARSLAN	MEHMET
					1/4	803	2	115	11543	SELİMNAZ ARSLAN	ALİ

Beşül Hacı  
Hüseyin Akkandisli  
Okul Sınıf No: 8797  
07.01.2025