



İLİ : YALOVA  
İLÇESİ : ÇINARCIK  
MAH : HARMANLAR  
PAFTA : G22D13A2C  
ADA : 461 623  
PARSEL : 2,3 1,2,3,4,5,6,8,9,10  
108,109,176,178,179

## PARSELASYON PLANI



1/1000

4 500 900

4 500 800

4 500 700

425 600

425 700

425 800

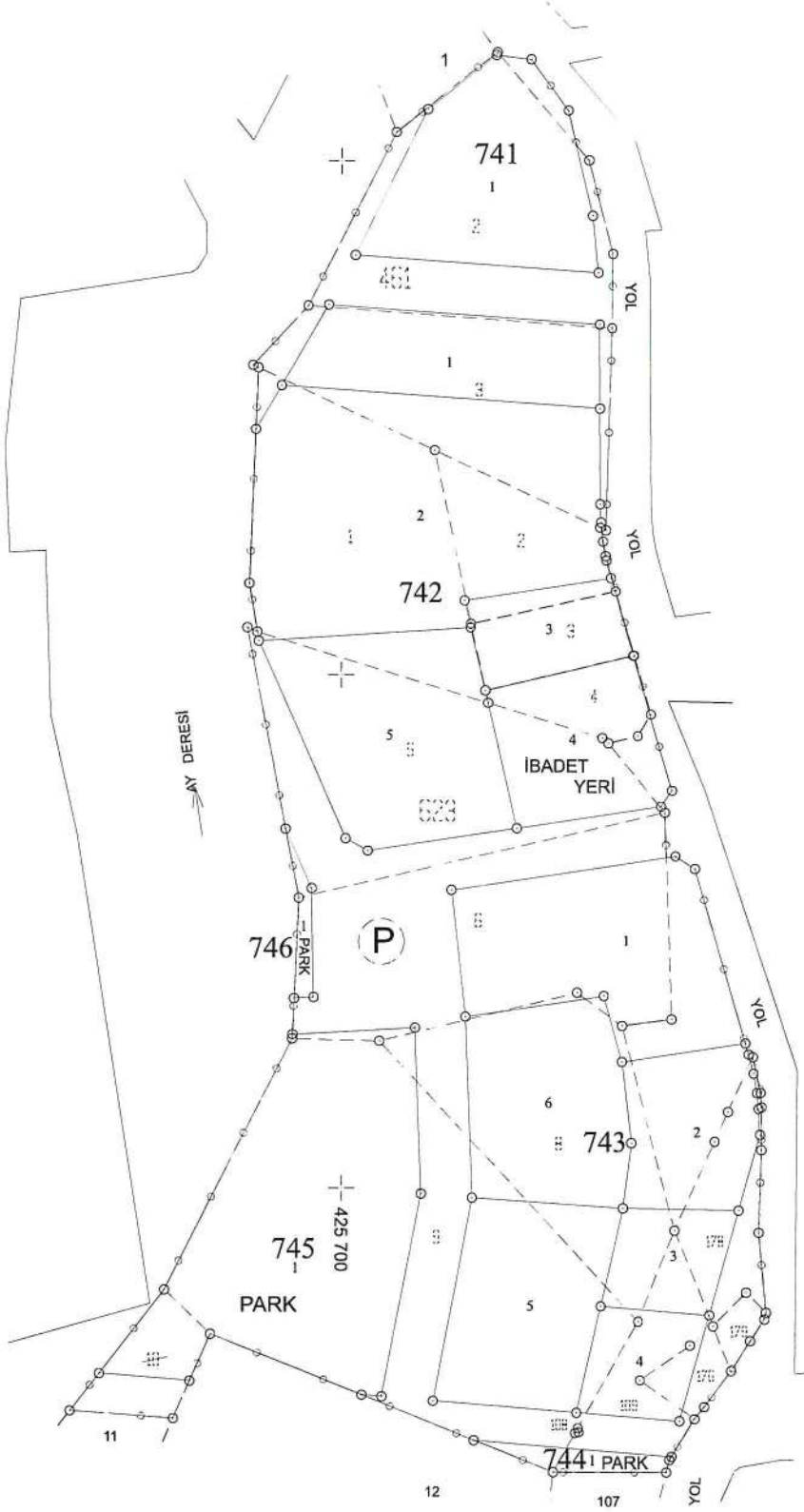

DÜZENLEYEN		UYGUNDUR BELEDİYE/ÖZEL İDARE	
ADI SOYADI	TARİH	KONTROL EDEN	ONAYLAYAN
Setül Tıncıl	Harita Müdürlüğü		
	Uda Sicil No: 18797		
	24.09.2024		

İLİ : YALOVA  
İLÇESİ : ÇINARCIK  
KÖY/MAH. : ÇINARCIK  
T.C. ÇINARCIK

BELEDİYESİ

NOLU UYGULAMA SAHASI

SAYFA NO: 1

Ö Z E T C E T V E L İ

K A D A S T R O

Ada/Par	Alan	Kamu.	Y.Terk	D.Girmeyen	Dopal	Dopalma	Dop	İ.Tahsis	AdaNo	Alın
461/2	2021.80	-	-	-	2021.80	-	700.72	1321.08	741	1321.08
461/3	1742.38	-	-	-	1742.38	-	603.87	1138.51	742	6188.27
623/1	1963.35	-	51.47	-	2014.82	-	698.30	1316.52	743	5504.06
623/2	674.96	-	17.69	-	692.65	-	240.06	452.59		
623/3	386.21	-	10.12	-	396.33	-	137.36	258.97		
623/4	317.79	-	-	-	0.00	317.79	0.00	317.79		
623/5	2339.27	-	-	-	2339.27	-	810.74	1528.53		
623/6	2369.49	-	-	-	2369.49	-	821.22	1548.27		
623/8	1774.27	-	-	-	1774.27	-	614.93	1159.34		
623/9	4374.96	-	-	-	4374.96	-	1516.26	2858.70		
623/10	357.45	-	-	-	357.45	-	123.89	233.56		
623/108	0.28	-	-	-	0.28	-	0.10	0.18		
623/109	594.40	-	-	-	594.40	-	206.01	388.39		
623/176	155.92	-	-	-	155.92	-	54.04	101.88		
623/178	517.69	-	-	-	517.69	-	179.42	338.27		
623/179	77.79	-	-	-	77.79	-	26.96	50.83		

K A D A S T R O T O P L A M L A R I

Toplam Pay	Toplam Alan	Top Kamu	Toplam Y.Terk	Toplam D.Girmeyen	Toplam Dopal	Top. Düz. Giren Dopalma	Dop	Toplam Tahsis	Toplam Alan
19668.01	19668.01	0.00	79.28	0.00	19429.50	317.79	6733.88	13013.41	13013.41

Düzenleme Ortaklık Payı Hesabı  
Kamuya Ayrılan Alan= 19747.29 - 13013.41 = 6733.88  
Düzenleme Ortaklık Payı = 6733.88 / 19429.50 = 0.3465802

  
Mustafa Tipli  
Harita Mühürsüresi  
Oda Sicil No: 18797  
24.09.2024







K A D A S T R O				İ M A R							
SNO	Pafta	Ada/Par	Alan/Pay	Hisse	Malik/Baba Adı	Kamu	Dop/iTh	Ada/Par	Alan	Hisse	Pay
1	G22D13A2C	461/2	2021.80 149.40	150 2030	YASARE YAVUZ MEHMET	-	51.78 97.62	741/1	1321.08	9762/132108	97.62
2	G22D13A2C	461/2	2021.80 258.46	519 4060	RİDVAN KARADENİZ KENAL	-	89.58 168.88	741/1	1321.08	16888/132108	168.88
3	G22D13A2C	461/2	2021.80 258.45	519 4060	ÖMER KARADENİZ KENAL	-	89.58 168.87	741/1	1321.08	16887/132108	168.87
4	G22D13A2C	461/2	2021.80 258.45	519 4060	AHMET KARADENİZ KENAL	-	89.58 168.87	741/1	1321.08	16887/132108	168.87
5	G22D13A2C	461/2	2021.80 258.45	519 4060	SÜHEYLA EFE KENAL	-	89.58 168.87	741/1	1321.08	16887/132108	168.87
6	G22D13A2C	461/2	2021.80 258.45	519 4060	SEVGİ PEHLİVAN KENAL	-	89.58 168.87	741/1	1321.08	16887/132108	168.87
7	G22D13A2C	461/2	2021.80 86.15	173 4060	SEVGİ PEHLİVAN KENAL	-	29.86 56.29	741/1	1321.08	5629/132108	56.29
8	G22D13A2C	461/2	2021.80 86.15	173 4060	RİDVAN KARADENİZ KENAL	-	29.86 56.29	741/1	1321.08	5629/132108	56.29
9	G22D13A2C	461/2	2021.80 86.15	173 4060	ÖMER KARADENİZ KENAL	-	29.86 56.29	741/1	1321.08	5629/132108	56.29
10	G22D13A2C	461/2	2021.80 86.15	173 4060	SÜHEYLA EFE KENAL	-	29.86 56.29	741/1	1321.08	5629/132108	56.29
11	G22D13A2C	461/2	2021.80 86.15	173 4060	AHMET KARADENİZ KENAL	-	29.86 56.29	741/1	1321.08	5629/132108	56.29
12	G22D13A2C	461/2	2021.80 37.35	15 812	NAFİA YAVUZ ALI	-	12.94 24.41	741/1	1321.08	2441/132108	24.41
13	G22D13A2C	461/2	2021.80 28.01	45 3248	KENAL YAVUZ CENAL	-	9.70 18.31	741/1	1321.08	1831/132108	18.31
14	G22D13A2C	461/2	2021.80 28.01	45 3248	FATMA HATİPOĞULLARI CENAL	-	9.70 18.31	741/1	1321.08	1831/132108	18.31
15	G22D13A2C	461/2	2021.80 28.01	45 3248	CANAN KOÇ CENAL	-	9.70 18.31	741/1	1321.08	1831/132108	18.31
16	G22D13A2C	461/2	2021.80 28.01	45 3248	FİLİZ YAVUZ CENAL	-	9.70 18.31	741/1	1321.08	1831/132108	18.31
17	G22D13A2C	461/3	1742.38 1742.38	TAM	AHMED SALEM OMAR BAL SALEM	-	603.87 1138.51	742/2	2907.62	113851/290762	1138.51

  
 Betül Tunc
   
 Fatma Mühürçisi
   
 Uda Sicil No: 48792

24.09.2024

SAYFA NO: 1

M A L S A H İ P L E R İ A R A Ş T I R M A

TOPLAM ALAN : 19747.29  
 TOPLAM PAY : 19747.29  
 TOPLAM KAMULAŞTIRMA : 0.00  
 TOP. DÜZENLE. GİRMEYEN: 0.00  
 TOP. DÜZENLEMENİYE GİREN: 19747.29

Ö Z E T F O R M U  
 ( KADASTRO PARSELINE SIRALI )

TOPLAM ADA ALANI : 13013.41  
 O.KATILIM ORANI : 0.000000  
 D.O.PAYI ORANI : 0.3465802

TOPLAM ALAN : 19747.29		M A L S A H İ P L E R İ A R A Ş T I R M A		SAYFA NO: 2							
TOPLAM PAY : 19747.29		Ö Z E T F O R M U		TOPLAM ADA ALANI : 13013.41							
TOPLAM KAMU : 0.00		( KADASTRO PARSELİNE SIRA LI )		O.KATILIM ORANI : 0.000000							
TOP. DÜZENLE. GİRMEYEN: 0.00				D.O.PAYI ORANI : 0.3465802							
TOP. DÜZENLEMEYE GİREN: 19747.29											
K A D A S T R O		İ M A R									
SNO	Pafsa	Ada/Par	Alan/Pay	Hisse	Malik/Baba Adı	Kamu	Dop/İth	Ada/Par	Alan	Hisse	Pay
18	G22D13A2C	623/1	2014.82 2014.82	TAM	AHMED SALEM OMAR BAL SALEM	-	698.30 1316.52	742/2	2907.62	131652/290762	1316.52
19	G22D13A2C	623/2	692.65 692.65	TAM	AHMED SALEM OMAR BAL SALEM	-	240.06 452.59	742/2	2907.62	45259/290762	452.59
20	G22D13A2C	623/3	396.33 396.33	TAM	YAVUZ SULTAN ÜZÜM AHMET ALİ	-	137.36 258.97	742/3	492.53	25897/49253	258.97
21	G22D13A2C	623/4	317.79 317.79	TAM	ÇINARCIK BELEDİYESİ	-	0.00 317.79	742/4	317.79	TAM	317.79
22	G22D13A2C	623/5	2339.27 389.87	1 6	HAFİZE AFAÇAN NUMAN	-	135.12 254.75	742/5	1528.53	25475/152853	254.75
23	G22D13A2C	623/5	2339.27 389.88	1 6	GÜNNEHAR COŞGUN NUMAN	-	135.12 254.76	742/5	1528.53	25476/152853	254.76
24	G22D13A2C	623/5	2339.27 389.88	1 6	NEBAHAT GÜLNAZ ARGÜL NUMAN	-	135.12 254.76	742/5	1528.53	25476/152853	254.76
25	G22D13A2C	623/5	2339.27 389.88	1 6	KEZİBAN YULAF NUMAN	-	135.12 254.76	742/5	1528.53	25476/152853	254.76
26	G22D13A2C	623/5	2339.27 389.88	1 6	HASAN ÖZEN NUMAN	-	135.12 254.76	742/5	1528.53	25476/152853	254.76
27	G22D13A2C	623/5	2339.27 129.96	1 18	HÜSNÜ SAĞIROĞLU MUSTAFA	-	45.04 84.92	742/5	1528.53	8492/152853	84.92
28	G22D13A2C	623/5	2339.27 129.96	1 18	SEVAL SAĞIROĞLU MUSTAFA	-	45.05 84.91	742/5	1528.53	8491/152853	84.91
29	G22D13A2C	623/5	2339.27 129.96	1 18	ECE BİNGÜL MUSTAFA	-	45.05 84.91	742/5	1528.53	8491/152853	84.91
30	G22D13A2C	623/6	2369.49 394.92	1 6	BİNGÜL UÇAR ALİ	-	136.88 258.04	743/1	1548.27	25804/154827	258.04
31	G22D13A2C	623/6	2369.49 394.92	1 6	MUZZEZ ÇETİNDAL ALİ	-	136.88 258.04	743/1	1548.27	25804/154827	258.04
32	G22D13A2C	623/6	2369.49 394.91	1 6	GÜNER EMEÇ ALİ	-	136.87 258.04	743/1	1548.27	25804/154827	258.04
33	G22D13A2C	623/6	2369.49 394.91	1 6	MUHİTTİN ÖZEN ALİ	-	136.87 258.04	743/1	1548.27	25804/154827	258.04
34	G22D13A2C	623/6	2369.49	1	AYLA ÖZEN	-	34.22	743/1	1548.27	6451/154827	64.51

  
 Hatice Münevver
   
 Eca Sicil No: 18/9
   
 24.03.2024



K A D A S T R O			İ M A R								
SNo	Pafta	Ada/Par	Alan/Pay	Hisse	Malik/Baba Adı	Kamu	Dop/İth	Ada/Par	Alan	Hisse	Pay
35	G22D13A2C	623/6	2369.49 148.09	1 16	EREN ÖZEN ÖMER	-	51.33 96.76	743/1	1548.27	9676/154827	96.76
36	G22D13A2C	623/6	2369.49 148.09	1 16	ERMAN ÖZEN ÖMER	-	51.33 96.76	743/1	1548.27	9676/154827	96.76
37	G22D13A2C	623/6	2369.49 98.73	1 24	MERAL ÖZEN HASAN	-	34.21 64.52	743/1	1548.27	6452/154827	64.52
38	G22D13A2C	623/6	2369.49 98.73	1 24	ÖZKAN ÖZEN HÜSEYİN	-	34.21 64.52	743/1	1548.27	6452/154827	64.52
39	G22D13A2C	623/6	2369.49 98.73	1 24	AYKUT ÖZEN HÜSEYİN	-	34.21 64.52	743/1	1548.27	6452/154827	64.52
40	G22D13A2C	623/6	2369.49 98.73	1 24	YASEMİN ÖZEN HÜSEYİN	-	34.21 64.52	743/1	1548.27	6452/154827	64.52
41	G22D13A2C	623/8	1774.27 295.72	1 6	EMİNE DER AHMET	-	102.50 193.22	743/6	1159.34	19322/115934	193.22
42	G22D13A2C	623/8	1774.27 591.42	1 3	PINAR ÇAKIR HASAN	-	204.97 386.45	743/6	1159.34	38645/115934	386.45
43	G22D13A2C	623/8	1774.27 887.13	1 2	CIHAN ALTUNBAŞ TAHSİN	-	307.46 579.67	743/6	1159.34	57967/115934	579.67
44	G22D13A2C	623/9	4374.96 4374.96	TAM	MEHMET OSMAN	-	1516.26 2858.70	742/1 743/2 743/5	941.80 757.63 1159.27	TAM TAM TAM	941.80 757.63 1159.27
45	G22D13A2C	623/10	357.45 178.73	1 2	FATMA ÖZYOL ALİ	-	61.95 116.78	742/3	492.53	11678/49253	116.78
46	G22D13A2C	623/10	357.45 178.72	1 2	HÜSEYİN BEKTAŞ ALİ	-	61.94 116.78	742/3	492.53	11678/49253	116.78
47	G22D13A2C	623/108	0.28 0.28	TAM	MALİYE HAZINESİ	-	0.10 0.18	743/4	439.40	18/43940	0.18
48	G22D13A2C	623/109	594.40 594.40	TAM	MALİYE HAZINESİ	-	206.01 388.39	743/4	439.40	38839/43940	388.39
49	G22D13A2C	623/176	155.92 155.92	TAM	MALİYE HAZINESİ	-	54.04 101.88	743/3	440.15	10188/44015	101.88
50	G22D13A2C	623/178	517.69 517.69	TAM	MALİYE HAZINESİ	-	179.42 338.27	743/3	440.15	33827/44015	338.27

SAYFA NO: 3

M A L S A H İ P L E R İ A R A Ş T I R M A

TOPLAM ALAN : 19747.29  
 TOPLAM PAY : 19747.29  
 TOPLAM KAMULAŞTIRMA : 0.00  
 TOP. DÜZENLE. GİRMEYEN: 0.00  
 TOP. DÜZENLEMESİNE GİREN: 19747.29

TOPLAM ADA ALANI : 13013.41  
 O. KATILIM ORANI : 0.000000  
 D.O.PAYI ORANI : 0.3465802

Ö Z E T F O R M U  
 ( KADASTRO PARSELİNE SİRALI )

TOPLAM ALAN TOPLAM PAY		19747.29 19747.29		M A L S A H İ P L E R İ A R A Ş T I R M A V E Ö Z E T F O R M U ( K A D A S T R O P A R S E L İ N E S I R A L I )		SAYFA NO: 4					
TOPLAM KAMULAŞTIRMA TOP. DÜZENLE. GİRMEYEN: TOP. DÜZENLEMENİ GİREN:		0.00 0.00 19747.29				TOPLAM ADA ALANI : 13013.41 O.KATILIM ORANI : 0.0000000 D.O.PAYI ORANI : 0.3465802					
K A D A S T R O				İ M A R							
SNo	Pafta	Ada/Par	Alan/Pay	Hisse	Malik/Baba Adı	Kamu	Dop/İth	Ada/Par	Alan	Hisse	Pay
51	G22D13A2C	623/179	77.79 77.79	TAM	MALİYE HAZINESİ	-	26.96 50.83	743/4	439.40	5083/43940	50.83

**BAY TİPÇİ**  
Halka Mühürçisi  
Tic. Sicil No: 18797

24.08.2024

TOPLAM ALAN : 19747.29 TOPLAM PAY : 19747.29 TOPLAM KAMULAŞTIRMA : 0.00 TOP. DÜZENLE. GİRMEYEN: 0.00 TOP. DÜZENLEMESİNE GİREN: 19747.29			T E S C İ L E E S A S D A Ğ İ T İ M C E T V E L İ ( İ M A R P A R S E L N E S İ R A L I )			TOPLAM ADA ALANI : 13013.41 O. KATILIM ORANI : 0.000000 D.O.PAYI ORANI : 0.3465802			SAYFA NO: 1		
SNO	Pafta	Ada/Par	Alan	K A S T R O		Dop/İth	Ada/Par	Alan	Hisse	Pay	
				Hisse	Kamu						
1	G22D13A2C	461/2	2021.80	150/2030	-	51.78	741/1	1321.08	9762/132108	97.62	
2		461/2	2021.80	149.40	-	89.58			16888/132108	168.88	
3		461/2	2021.80	258.45	-	168.88			16887/132108	168.87	
4		461/2	2021.80	258.45	-	168.87			16887/132108	168.87	
5		461/2	2021.80	258.45	-	168.87			16887/132108	168.87	
6		461/2	2021.80	258.45	-	168.87			16887/132108	168.87	
7		461/2	2021.80	173/4060	-	56.29			5629/132108	56.29	
8		461/2	2021.80	86.15	-	29.86			5629/132108	56.29	
9		461/2	2021.80	86.15	-	29.86			5629/132108	56.29	
10		461/2	2021.80	86.15	-	29.86			5629/132108	56.29	
11		461/2	2021.80	86.15	-	29.86			5629/132108	56.29	
12		461/2	2021.80	15/812	-	12.94			2441/132108	24.41	
13		461/2	2021.80	37.35	-	24.41			1831/132108	18.31	
14		461/2	2021.80	28.01	-	9.70			1831/132108	18.31	
15		461/2	2021.80	45/3248	-	18.31			1831/132108	18.31	
16		461/2	2021.80	28.01	-	9.70			1831/132108	18.31	
44	G22D13A2C	623/9	4374.96	TAM 4374.96	-	1516.26 2858.70	742/1	941.80	TAM	941.80	
17	G22D13A2C	461/3	1742.38	TAM 1742.38	-	603.87 1138.51	742/2	2907.62	113851/290762	1138.51	
18		623/1	2014.82	TAM 2014.82	-	698.30 1316.52			131652/290762	1316.52	
19		623/2	692.65	TAM 692.65	-	240.06 452.59			45259/290762	452.59	
20	G22D13A2C	623/3	396.33	TAM 396.33	-	137.36 258.97	742/3	492.53	25897/49253	258.97	
45		623/10	357.45	1/2 178.73	-	61.95 116.78			11678/49253	116.78	
46		623/10	357.45	1/2 178.72	-	61.94 116.78			11678/49253	116.78	

Belediye Başkanı  
Hacı Mehmetçis  
Ada Sicil No: 10797

24.08.2024

TOPLAM ALAN : 19747.29			T E S C İ L E E S A S			SAYFA NO: 2					
TOPLAM PAY : 19747.29			D A Ğ İ T İ M C E T V E L İ			TOPLAM ADA ALANI : 13013.41					
TOPLAM KAMULAŞTIRMA : 0.00			( İ M A R P A R S E L İ N E S İ R A L I )			O.KATILIM ORANI : 0.0000000					
TOP. DÜZENLEME GİRMEYEN: 0.00						D.O.PAYI ORANI : 0.3465802					
TOP. DÜZENLEMEYE GİREN: 19747.29											
K A D A S T R O			İ M A R								
SNo	Pafta	Ada/Par	Alan	Hisse	Malik/Baba Adı	Kamu	Dop/İth	Ada/Par	Alan	Hisse	Pay
21	G22D13A2C	623/4	317.79	TAM 317.79	ÇINARCIK BELEDİYESİ	-	0.00 317.79	742/4	317.79	TAM	317.79
22	G22D13A2C	623/5	2339.27	1/6 389.87	HAFİZE AFACAN	-	135.12 254.75	742/5	1528.53	25475/152853	254.75
23		623/5	2339.27	1/6 389.88	NUMAN	-	135.12 254.76			25476/152853	254.76
24		623/5	2339.27	1/6 389.88	GÜNNEHAR COŞGUN	-	135.12 254.76			25476/152853	254.76
25		623/5	2339.27	1/6 389.88	NEBAHAT GÜLNAZ ARGÜL	-	135.12 254.76			25476/152853	254.76
26		623/5	2339.27	1/6 389.88	KEZİBAN YULAF	-	135.12 254.76			25476/152853	254.76
27		623/5	2339.27	1/18 129.96	HASAN ÖZEN	-	135.12 254.76			25476/152853	254.76
28		623/5	2339.27	1/18 129.96	NUMAN	-	45.04			8492/152853	84.92
29		623/5	2339.27	1/18 129.96	HUSNU SAĞIROĞLU	-	45.05			8491/152853	84.91
30	G22D13A2C	623/6	2369.49	1/6 394.92	MUSTAFA	-	45.05			8491/152853	84.91
31		623/6	2369.49	1/6 394.92	SEVAL SAĞIROĞLU	-	84.91			8491/152853	84.91
32		623/6	2369.49	1/6 394.91	MUSTAFA	-	84.91			8491/152853	84.91
33		623/6	2369.49	1/6 394.91	ECCE BİNGÜL	-	84.91			8491/152853	84.91
34		623/6	2369.49	1/24 98.73	MUSTAFA	-	84.91			8491/152853	84.91
35		623/6	2369.49	1/16 148.09	BİNGÜL UÇAR	-	136.88	743/1	1548.27	25804/154827	258.04
36		623/6	2369.49	1/16 148.09	ALI	-	258.04			25804/154827	258.04
37		623/6	2369.49	1/24 98.73	MUZZEZ ÇETİNDAL	-	258.04			25804/154827	258.04
38		623/6	2369.49	1/16 148.09	ALI	-	136.87			25804/154827	258.04
39		623/6	2369.49	1/24 98.73	GÜNER EMEÇ	-	258.04			25804/154827	258.04
40		623/6	2369.49	1/24 98.73	ALI	-	258.04			25804/154827	258.04
41		623/6	2369.49	1/24 98.73	MUHİTTİN ÖZEN	-	34.22			6451/154827	64.51
42		623/6	2369.49	1/16 148.09	AYLA ÖZEN	-	64.51			9676/154827	96.76
43		623/6	2369.49	1/16 148.09	TURHAN	-	51.33			9676/154827	96.76
44		623/6	2369.49	1/16 148.09	EREN ÖZEN	-	96.76			9676/154827	96.76
45		623/6	2369.49	1/24 98.73	EMER	-	51.33			9676/154827	96.76
46		623/6	2369.49	1/24 98.73	ERMAN ÖZEN	-	51.33			9676/154827	96.76
47		623/6	2369.49	1/24 98.73	EMER	-	96.76			9676/154827	96.76
48		623/6	2369.49	1/24 98.73	MERAL ÖZEN	-	34.21			6452/154827	64.52
49		623/6	2369.49	1/24 98.73	HASAN ÖZEN	-	34.21			6452/154827	64.52
50		623/6	2369.49	1/24 98.73	ÖZKAN ÖZEN	-	34.21			6452/154827	64.52
51		623/6	2369.49	1/24 98.73	HÜSEYİN	-	64.52			6452/154827	64.52
52		623/6	2369.49	1/24 98.73	AYKUT ÖZEN	-	34.21			6452/154827	64.52
53		623/6	2369.49	1/24 98.73	HÜSEYİN	-	64.52			6452/154827	64.52
54		623/6	2369.49	1/24 98.73	HÜSEYİN ÖZEN	-	34.21			6452/154827	64.52
55		623/6	2369.49	1/24 98.73	HÜSEYİN	-	64.52			6452/154827	64.52
56	G22D13A2C	623/9	4374.96	TAM 4374.96	MEHMET OSMAN	-	1516.26 2858.70	743/2	757.63	TAM	757.63
57	G22D13A2C	623/176	155.92	TAM 155.92	MALİYE HAZİNESİ	-	54.04	743/3	440.15	10188/44015	101.88
58		623/178	517.69	TAM 517.69	MALİYE HAZİNESİ	-	101.88 179.42 338.27			33827/44015	338.27

  
 Mustafa Tırıcı  
 Harita Mühendisi  
 Oda Sicil No: 18797  
 24.09.2024

K A D A S T R O				T E S C İ L E E S A S				İ M A R			
SNO	Pafta	Ada/Par	Alan	Hisse	Malik/Baba Adı	Kamu	Dop/iTh	Ada/Par	Alan	Hisse	Pay
47	G22D13A2C	623/108	0.28	TAM 0.28	MALİYE HAZİNESİ	-	0.10	743/4	439.40	18/43940	0.18
48		623/109	594.40	TAM 594.40	MALİYE HAZİNESİ	-	206.01 388.39			38839/43940	388.39
51		623/179	77.79	TAM 77.79	MALİYE HAZİNESİ	-	26.96 50.83			5083/43940	50.83
44	G22D13A2C	623/9	4374.96	TAM 4374.96	MEHMET OSMAN	-	1516.26 2858.70	743/5	1159.27	TAM	1159.27
41	G22D13A2C	623/8	1774.27	1/6 295.72	EMİNE DER AHMET	-	102.50 193.22	743/6	1159.34	19322/115934	193.22
42		623/8	1774.27	1/3 591.42	PINAR ÇAKIR HASAN	-	204.97 386.45			38645/115934	386.45
43		623/8	1774.27	1/2 887.13	CIHAN ALTUNBAŞ TAHSİN	-	307.46 579.67			57967/115934	579.67

TOPLAM ALAN : 19747.29  
TOPLAM PAY : 19747.29  
TOPLAM KAMULAŞTIRMA : 0.00  
TOP. DÜZENLE. GİRMEYEN: 0.00  
TOP. DÜZENLEMESİNE GİREN: 19747.29

D A Ğ İ T İ M C E T V E L İ  
( İ M A R P A R S E L İ N E S İ R A L I )

TOPLAM ADA ALANI : 13013.41  
O.KATILIM ORANI : 0.000000  
D.O.PAYI ORANI : 0.3465802

SAYFA NO: 3

  
Mühür  
Mühendis:  
Sicil No: 18797  
24.09.2024

İLİ : YALOVA  
İLÇESİ : ÇINARCIK  
KÖY/MAH.İ : ÇINARCIK  
BELEDİYESİ : ÇINARCIK  
PAFTANO : G22D13A2C

T E S C İ L  
S A Y F A S I

SAYFA NO: 1

ADANO : 741

ClT	Syf	ParNo	Alan		Cinsi	Hisse	K A D A S T R O					Babası
			He.	M2			Dm2	KAda	KPar	Cilt	Syf.	
		1	0	1321	08	ARSA	461	2	8	713	YAŞARE YAVUZ	MEHMET
						150/2030	461	2	8	713	RİDVAN KARADENİZ	KEMAL
						519/4060	461	2	8	713	ÖMER KARADENİZ	KEMAL
						519/4060	461	2	8	713	AHMET KARADENİZ	KEMAL
						519/4060	461	2	8	713	SÜHEYLA EFE	KEMAL
						519/4060	461	2	8	713	SEVGİ PEHLİVAN	KEMAL
						865/4060	461	2	8	713	SEVGİ PEHLİVAN	KEMAL
							461	2	8	713	RİDVAN KARADENİZ	KEMAL
							461	2	8	713	ÖMER KARADENİZ	KEMAL
							461	2	8	713	SÜHEYLA EFE	KEMAL
							461	2	8	713	AHMET KARADENİZ	KEMAL
							461	2	8	713	NAFİA YAVUZ	ALİ
							461	2	8	713	KEMAL YAVUZ	CEMAL
							461	2	8	713	FATMA HATİPOĞULLARI	CEMAL
						240/3248	461	2	8	713	CANAN KOÇ	CEMAL
							461	2	8	713	FİLİZ YAVUZ	CEMAL

  
Farida Mühendis;  
Oda Sicil No: 18797  
24.08.2024

İLİ : YALOVA  
İLÇESİ : ÇINARCIK  
KÖY/MAH.İ : ÇINARCIK  
BELEDİYESİ : ÇINARCIK  
PAFTANO : G22D13A2C

Clt	Syf	ParNo	Alan		Cinsi	Hisse	KAda	KPar	Cilt	Syf.	Maliki	Babası
			He.	M2								
1	0	941	80	ARSA	TAM	623	9	7	675	MEHMET	OSMAN	
2	0	2907	62	ARSA	113851/290762 131652/290762 45259/290762	623	3	8	712	AHMED SALEM OMAR BALAHMAR AHMED SALEM OMAR BALAHMAR AHMED SALEM OMAR BALAHMAR	SALEM SALEM SALEM	
3	0	492	53	ARSA	25897/49253 11678/49253 11678/49253	623	3	67	6709	YAVUZ SULTAN ÜZÜM FATMA ÖZYOL HÜSEYİN BEKTAŞ	AHMET ALİ ALİ ALİ	
4	0	877	37	İBADET YERİ	31779/87737 55958/87737	623	4	67	6708	ÇINARCIK BELEDİYESİ MALİYE HAZİNESİ	-	
5	0	1528	53	ARSA	1/6 1/6 1/6 1/6 1/6 1/6	623	5	7	678	GÜNNEHAR COŞGUN HAFİZE AFACAN HASAN ÖZEN KEZİBAN YULAF NEBAHAT GÜLNAZ AKGÜL HÜSNÜ SAĞIROĞLU SEVAL SAĞIROĞLU ECE BİNGÜL	NUMAN NUMAN NUMAN NUMAN NUMAN MUSTAFA MUSTAFA MUSTAFA	

  
Hatice Mühendis  
Oda Sicil No: 18797  
21.08.2024

İLİ : YALOVA  
İLÇESİ : ÇINARCİK  
KÖY/MAH.İ : ÇINARCİK  
BELEDİYESİ : ÇINARCİK  
PAFTANO : G22D13A2C

Clt	Syf	ParNo	Alan		Cinsi	Hisse	KAda	KPar	Cilt	Syf.	Maliki	Babası
			He.	M2								
		1	0	1548	27	ARSA	1/6 1/6 1/6 1/6 1/24 1/24 1/24 1/24 1/6	6 6 6 6 6 6 6 6 6 6 6	7 7 7 7 7 7 7 7 7 7 7	677 677 677 677 677 677 677 677 677 677 677	BİNGÜL UÇAR MUAZZEZ ÇETİNDAL MUHİTTİN ÖZEN GÜNER EMEÇ MERAL ÖZEN ÖZKAN ÖZEN AYKUT ÖZEN YASEMİN ÖZEN AYLA ÖZEN EREN ÖZEN ERMAN ÖZEN	ALİ ALİ ALİ ALİ HASAN HÜSEYİN HÜSEYİN HÜSEYİN TURHAN ÖMER ÖMER
		2	0	757	63	ARSA	TAM	9	7	675	MEHMET	OSMAN
		3	0	440	15	ARSA	10188/44015 33827/44015	176 178	120 120	1197 1197	MALİYE HAZİNESİ MALİYE HAZİNESİ	- -
		4	0	439	40	ARSA	18/43940 38839/43940 5083/43940	108 109 179	119 119 120	1190 1191 1198	MALİYE HAZİNESİ MALİYE HAZİNESİ MALİYE HAZİNESİ	- - -
		5	0	1159	27	ARSA	TAM	9	7	675	MEHMET	OSMAN
		6	0	1159	34	ARSA	1/2 1/6 1/3	8 8 8	7 7 7	676 676 676	CİHAN ALTUNBAŞ EMİNE DER PINAR ÇAKIR	TAHSİN AHMET HASAN